

## iMotion® 1401 Swing Door Drive



intelligent



modular



ecological



reliable



economical

<b>Areas of application</b>	– external and internal doors, 1- and 2-leaf – fire doors*
<b>Variants</b>	iMotion 1401.FIRE (fire protection)
<b>Options</b>	– air lock function – fire- and smoke doors – nurse-bed function – integration into building management systems – user interface, 3 resp. 6 operating modes – key switch
<b>Drive type</b>	– electromechanical – motor opening, spring closing – spring opening, motor closing
<b>Motor</b>	AC permanent magnet, synchronous motor
<b>Control system</b>	micro-processor (32 Bit/30 MHz)
<b>Mains connection</b>	1 × 230/1 × 115 V AC, 50 ... 60 Hz, 10 A
<b>Power consumption</b>	4 ... 250 VA
<b>Inputs</b>	8 programmable inputs, of which 4 testable safety features, expandable by modules
<b>Outputs</b>	3 programmable, short circuit-proof, expandable by modules
<b>Sensor power supply</b>	24 V DC/1,5 A
<b>Electric latch</b>	6 ... 24 V DC/max. 24 W, max. 2 A
<b>Interfaces</b>	RS232, LIN bus, CAN bus
<b>Approvals</b>	CE incl. RoHS, TÜV, ETL, DIBt
<b>Standards</b>	DIN 18650/EN 16005, EN 60335-1, EN 61000-6-2, EN 61000-6-3, UL 325, DIN 18263-4

<b>Durability</b>	class 3 to DIN 18650-1: 2010
<b>Protective class (drive)</b>	IP 67
<b>Ambient temperature</b>	–20 °C to +50 °C
<b>Installation location</b>	invisible, installed in the floor
<b>Double leaf doors</b>	master-slave
<b>Dimensions</b>	450 × 293 × 127 mm
<b>Tare weight</b>	39 kg
<b>Door sizes to DIN 1154</b>	4...6
<b>Inertia, door leaf</b>	150 kgm <sup>2</sup>
<b>Angle of opening</b>	0 ... 100° infinitely variable
<b>Opening speed</b>	up to max. of 45°/s
<b>Closing speed</b>	up to max. of 45°/s
<b>Hold open time</b>	0 ... 60s; permanently open

### Maximum door leaf weights

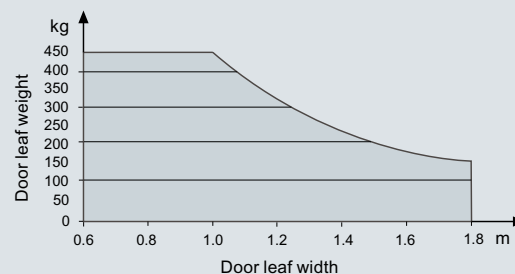

\*only iMotion 1401.FIRE

### Floor covering mounting frame



With integrated door arm

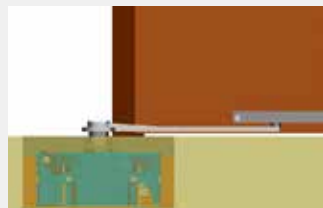

Pulling linkage

### Stainless steel cover plate



With integrated door arm

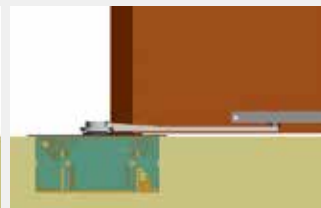

Pulling linkage