



## FGP Cycle Stand

The FGP Seat is organic in form and sophisticated in its simplicity. The subtly concave curvature of the cast aluminium structural frames gives it a soft appearance. The back height is designed to allow a sitter to rest an arm on it, making it feel relaxed and welcoming. Seats are offered in single and double lengths and are scalable. The single seat has a frame at each end, while the double seat has a frame at each end and one in the center. The timber slats are more than an inch thick with the front slat elegantly detailed to curve around the seat frame. Slats are available in standard Landscape Forms timbers in North America and regionally sourced wood in international markets. Cast aluminium parts have a handsome and durable anodized finish.

### Specification

#### Materials

Frame / Top - cast aluminium

### Dimensions

H: 814mm  
W: 760mm  
D: 88mm

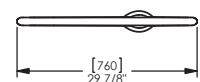
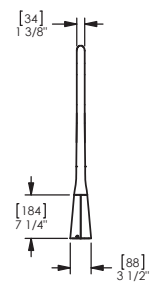
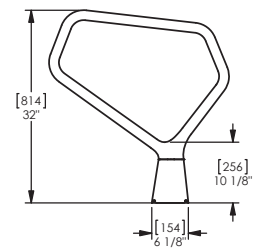

**artform**  
urban furniture