

# MEA TSH 150 TOPSLOT

A 15, B 125, C 250, D 400\*\*, E 600\*\*

CW 150



**BUILDING SUCCESS**

## PURPOSE OF USE

Channel covers for MEA drainage channels, as part of a drainage system to catch, transport and evacuate rainwater from adjoining surfaces.

\*\* Not suitable for the diagonal or transverse travel of motorways and highways.

# MEA TSH 150 TOPSLOT

A 15, B 125, C 250, D 400\*\*, E 600\*\*

CW 150

## MEA TSH 150 TOPSLOT

MEA TSH 150 TOPSLOT suitable for channel systems **MEARIN PLUS/EXPERT 150, MEARIN PLUS F 150, MEADRAIN EN 1500, MEADRAIN SV/SE/SG 1500** and **MEADRAIN SVF/SEF 1500**. Covers all ranges of applications. Loading classes A 15 to E 600\*\* according to EN 1433. Load capacity according to specification, when installed according to the MEA installation instructions.

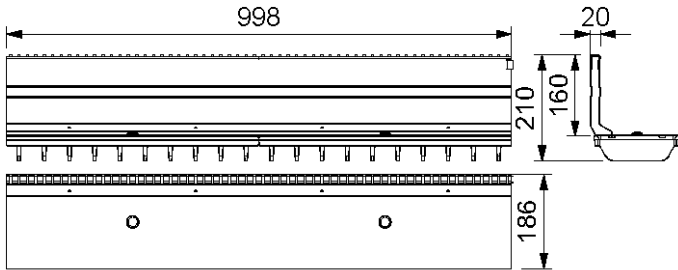

012152887

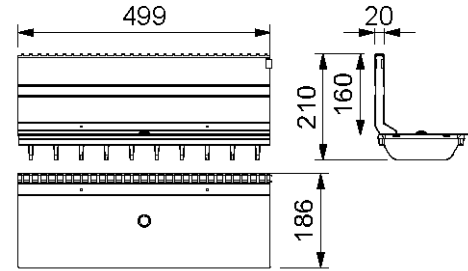

012152889

## MEA TSH 150 TOPSLOT LATERAL, NECK HEIGHT 160 MM, LOADING CLASS E 600 ACCORDING TO EN 1433 \*\*)

Designation	Ord. No.	Material	Length [mm]	Inlet sect. area Ø cm <sup>2</sup> /m above	kg/unit
MEA TSH 150.0 / 160 TOPSLOT-E 600-Galv.-1 m-lateral incl. 2 Ductile Iron grates **)	012152887	Galv. steel	1000	96	17,60
MEA TSH 150.1 / 160 TOPSLOT-E 600-Galv.-0,5 m-lateral incl. Ductile Iron grating *) **)	012152889	Galv. steel	500	96	8,80
MEA TSH 150.0 / 160 TOPSLOT-E 600-Stainl.steel-1 m-lateral incl. 2 Ductile Iron grates *) **)	012152891	Stainl. steel	1000	96	17,60
MEA TSH 150.1 / 160 TOPSLOT-E 600-Stainl.steel-0,5 m-lateral incl. Ductile Iron grating *) **)	012152893	Stainl. steel	500	96	8,80

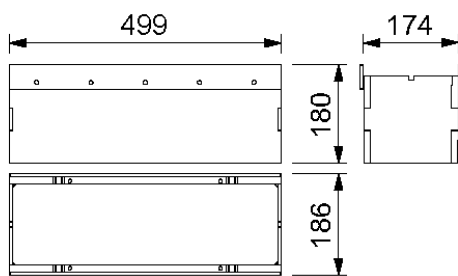

012152899

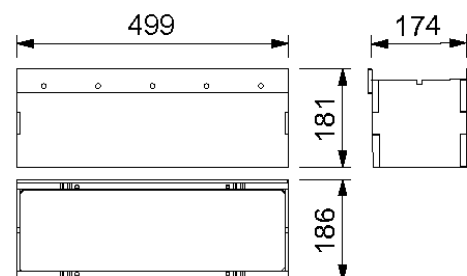

012152896

## MEA TSH 150 INSPECTION ELEMENT UPPER PART, LOADING CLASS E 600 ACCORDING TO EN 1433 \*\*)

Designation	Ord. No.	Material	Length [mm]	Inlet sect. area Ø cm <sup>2</sup> /m above	kg/unit
MEA TSH 150.R / 160 Inspection element upper part-E 600-Galv.-0,5 m **)	012152899	Galv. steel	500	-	19,20
MEA TSH 150.R / 160 Inspection element upper part-E 600-Stainl.steel-0,5 m *) **)	012152896	Stainl. steel	500	-	19,20

\* Delivery time on demand.

\*\* Not suitable for the diagonal or transverse travel of motorways and highways.

# MEA TSH 150 TOPSLOT

A 15, B 125, C 250, D 400\*\*, E 600\*\*

CW 150



BUILDING SUCCESS

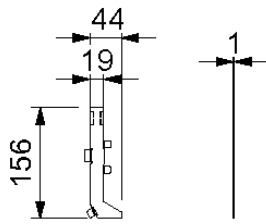

012159030

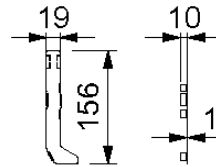

012159030 Left

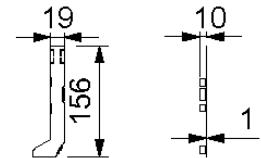

012159030 Right

## MEA TSH 150, END CAPS

Designation	Ord. No.	Material	Height [mm]	kg/unit
MEA TSH End cap made of galvanised steel	012159030	Galv. steel	156	0,03
MEA TSH End cap made of stainless steel *)	012159031	Stainl. steel	156	0,03

## MEA TSH TOPSLOT ACCESSORIES

Designation	Ord. No.	Material	kg/unit
MEA TSH Construction cover-S, 1 m for TOPSLOT *)	010159893	Galv. steel	0,29
MEA TSH Construction cover-R, 0,5 m for revision attachment *)	010159895	Galv. steel	0,16
MEA TSH plastic caps for Inspection element upper part-thread for replacement delivery	010152866	PP	0,01
MEA TSH quick connector for grating for replacement delivery	010152900	PP	0,01
MEA TSH assembly tool – 2 items necessary	010152858	Galv. steel	0,19

\* Delivery time on demand.

\*\* Not suitable for the diagonal or transverse travel of motorways and highways.

# MEA TSH 150 TOPSLOT

A 15, B 125, C 250, D 400\*\*, E 600\*\*

CW 150



BUILDING SUCCESS

## CHANNEL COVERS FOR MEA TSH 150 INSPECTION ELEMENT UPPER PART

With bolted cover. Exclusively for MEA TSH 150 inspection top piece. Total width of the gratings 172 mm

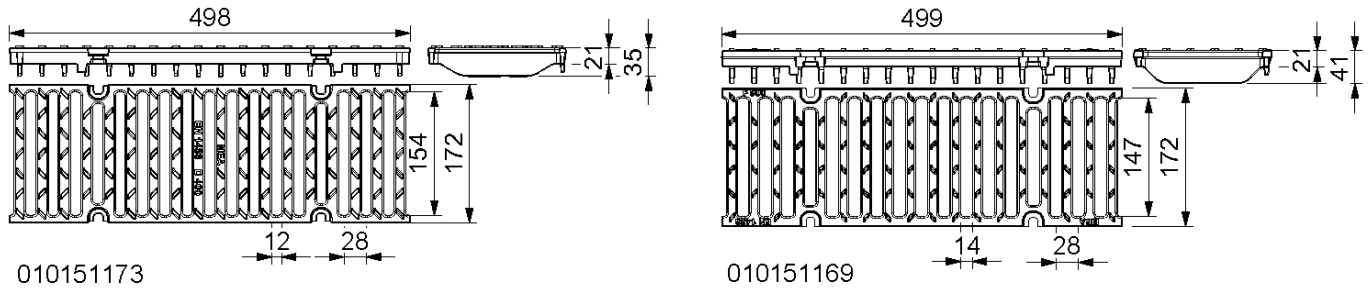

## LOADING CLASSES D 400 TO E 600 ACCORDING TO EN 1433, 4-FOLD BOLTED FOR MEA TSH 150 INSPECTION ELEMENT UPPER PART \*\*)

Designation	Ord. No.	Material	Length [mm]	Inlet sect. area Ø cm <sup>2</sup> /m above	kg/unit
MEA 150 Ductile iron slotted grating-D 400-0,5 m 12/154 bolt fixing required **) ****)	010151173	Ductile iron	500	630	6,20
MEA 150 Ductile iron slotted grating-F 900-0,5 m 12/147 bolt fixing required **) ****)	010151169	Ductile iron	500	523	8,46
MEA TSH 150/200/300 Grating locking bolt with washer for inspection element, 4 pieces/grating will be needed *)	010153104	Stainl. steel	-	-	0,02

\* Delivery time on demand.

\*\* Not suitable for the diagonal or transverse travel of motorways and highways.

\*\*\*\* The surface coating of ductile iron parts only has a temporary and cosmetic function. Ductile iron is virtually impervious to surface oxidation from environmental influences (e.g. thawing salt). Superficial rust does not constitute a product defect. Of course, the resignation of surface coating is in accordance with all corresponding standards

This edition of the technical data sheet shall be valid from March 2022 until a revised version is published and replaces any previous publications. The respectively current version is available for download at [www.mea-group.com](http://www.mea-group.com).

MEA Bautechnik GmbH  
 Business unit MEA Water Management  
 Sudetenstraße 1  
 86551 Aichach  
 Tel.: +49 (0) 82 51. 91 0  
 Fax: +49 (0) 82 51. 91 13 06  
 E-Mail: [info@mea-group.com](mailto:info@mea-group.com)  
[www.mea-group.com](http://www.mea-group.com)